



NEW

LOP

FIXTURES

AUTHORISED UK DISTRIBUTORS FOR

VEGA®

ITALIAN STYLE FOR LIFTS

*In*  
**STOCK**  
*Now*



**SURFACE MOUNT**

H300  
W110

25mm &  
35mm DEEP

INCLUDES ACHILLE  
OR ERCOLE PUSHES

EN81-70  
EN81-71





PEW Electrical Distributors



## SURFACE Line LOPs

Vandal resistant surface mounted Landing Operating Panels featuring mounting plate and steel end caps

### MAIN FEATURES:

- Robust yet stylish surface mounted LOPs
- Fixture fabricated from 2mm hairline stainless steel
- LOP sizes: W110 x H300 x D25mm for ACHILLE (Class 1)
- LOP sizes: W110 x H300 x D35mm for ERCOLE (Class 2)
- End caps: stainless steel AISI 304 laser-cut
- 1, 2 and 3 hole arrangements in stock
- Steel frame mounting back plate for easy installation
- **NOTE: Other sizes available on request for COP, LIP and LOP**

EN 81-70

EN 81-71

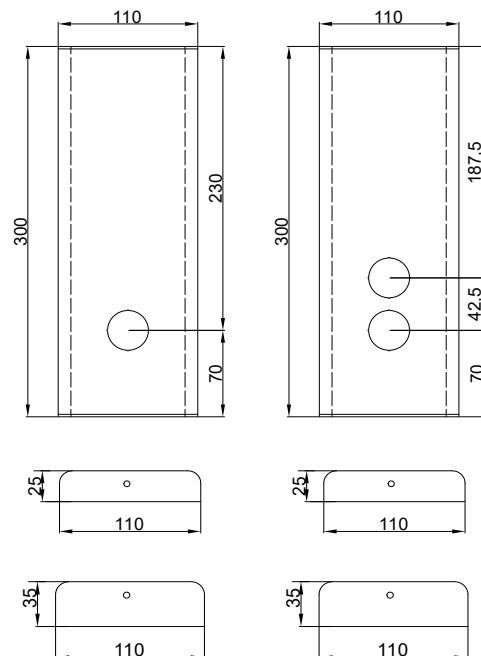

EN 81-71 Class 1

Achille Black  
ACH BK



EN 81-71 Class 2

Ercole Black  
ERC BK



### Illumination Styles



### Surface Line LOP order codes

Holes - Wide High Deep Finish	Push Pressel / LED	Legend	Key Switch	EN Buzzer
SUR1-110 300 25 SS	ACH BK / RE	ARW	1P1E (1 pos 1 remove)	BIP
SUR2-110 300 25 SS	ACH BK / BL	DA (double arrow)	2P1E (2 pos 1 remove)	
SUR3-110 300 25 SS	ACH BK / WB		2P2E (2 pos 2 remove)	
SUR1-110 300 35 SS	ERC BK / RE			
SUR2-110 300 35 SS	ERC BK / BL			
SUR3-110 300 35 SS				

Assembled to your configuration from stock.  
Call or email us for prices and availability.

### EXAMPLE ORDER CODE:

SUR2-11030035SS + ERCBK/REARW + BIP

Surface LOP with 2 Holes W110xH300xD35 Stainless Steel finish with 2 x Ercole Black, Red LED 12/24V 1sw, Arrow, with Latched Buzzer

PEW Electrical Distributors Ltd

Unit 1 The iO Centre  
59-71 River Road  
Barking, Essex IG11 0DR

0208 507 1001

sales@pewelectrical.com  
www.pewelectrical.com

