

SLIM LADDER



Se trata de un producto diseñado para instalarse en espacios reducidos. Está fabricada en acero galvanizado y aluminio.

Se ha diseñado para satisfacer los requisitos de la EN81-21 y la EN81-20, y de manera que pueda adaptarse dimensionalmente a la mayoría de las instalaciones.

This is a product designed to be installed in narrow shafts. It is manufactured in galvanized steel and aluminum.

It has been designed to meet the requirements of the **EN81-21** and **EN81-20**, and it can adapt dimensionally to most of the applications in the field

COMPACIDAD/COMPACTNESS
130x47

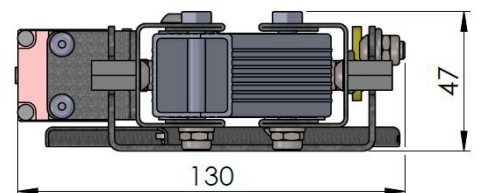

SLIM LADDER

Cómo hacer un pedido / How to order:

Mod
L200

Mod.	L (mm)	L2 (mm)	L3 (mm)	L4 (mm)	L5 (mm)	N steps	Altura Foso/Pit Height (mm)	Safety Switch
L050	1845	2152	695	47	42	3	500-680	1NC/1NO: EN 81-20 (2020) 5.11.2 COMPLIANT
L100	2135	2442	984			4	681-960	
L200	2425	2732	1274			5	961-1241	
L300	2815	3122	1564	54	48	6	1242-1618	
L400	3105	3412	1854			7	1619-1900	

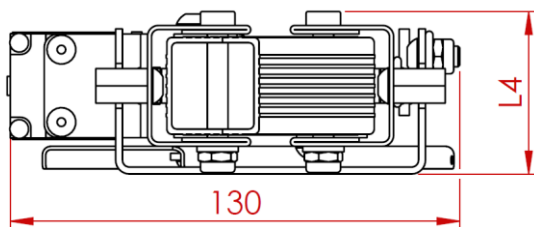
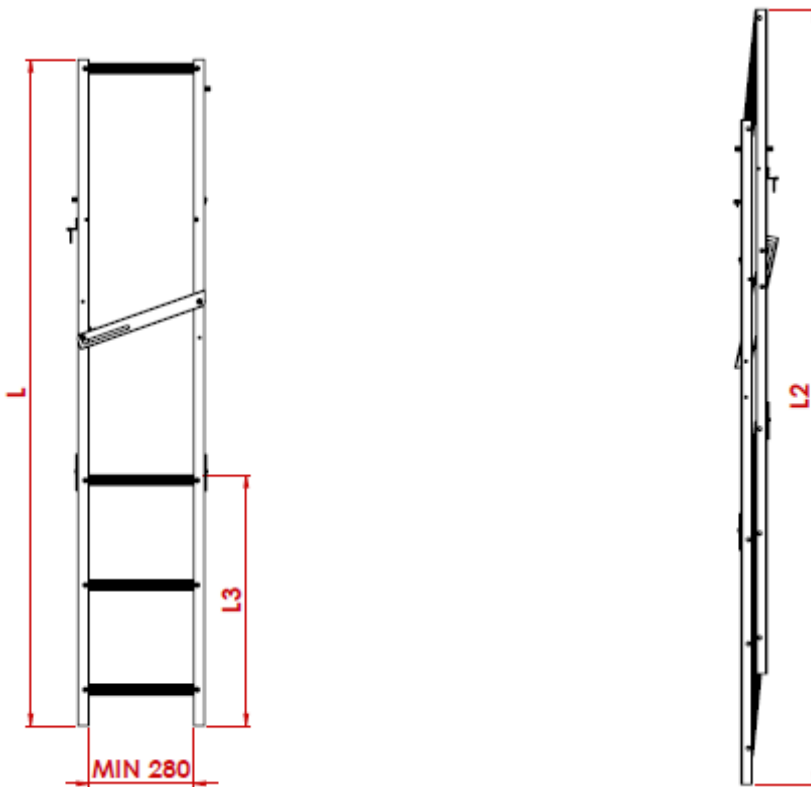

Soporte / Bracket

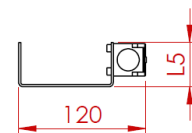
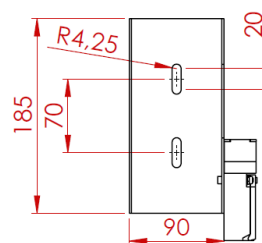

Nota/Note: La información proporcionada en este catálogo no vinculante, y no se debería usar como sustituto de consultas individuales detalladas.
This catalogue provides non-binding general information, and should not be used as a substitute for a detailed individual consultation.