

Joint Alignment Tool

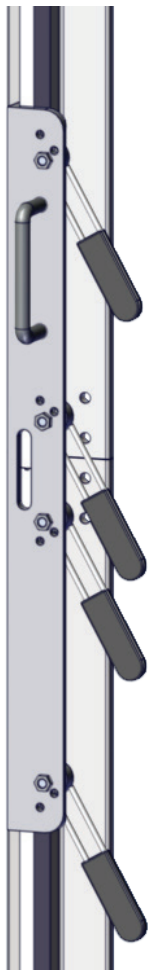
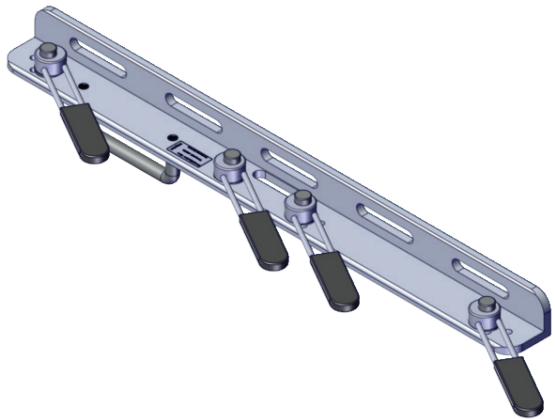

Description

Properly aligning elevator rails at the joint can be difficult, and if done incorrectly can lead to a bad ride or hours of filing and dressing the rail joint. This issue is dramatically improved by using the joint alignment tool. This tool, made primarily of aluminum will allow you to clamp your rails into the correct position at the rail joint using the cam handles provided. Once the fish plate is tightened the joint alignment tool is removed leaving you with a smooth and proper rail joint. Use this tool to save time and improve the quality of your rail joints. Works on all rails with faces between 3/8"(10 mm) and 1 1/4" (32 mm) thick.

ISO Rail Size	Rail Blade Width (in./mm)
T75-3	3/8" (10 mm)
T89	5/8" (16 mm)
T90	5/8" (16 mm)
T114	5/8" (16 mm)
T127-1	5/8" (16 mm)
T127-2	5/8" (16 mm)
T140-1	3/4" (19)
T140-2	1 1/8" (28.6 mm)
T140-3	1 1/4" (32 mm)